

AN ORDINANCE AMENDING KING COUNTY ZONING RESOLUTION NO. 25789, AS AMENDED BY AMENDING THE ZONING MAP THEREOF RECLASSIFYING CERTAIN PROPERTY THEREON.

WHEREAS JOHN DAVIES has petitioned King County, requesting reclassification of property described in said petition and all legal requirements have been performed; and

WHEREAS, the Department of Planning has transmitted to the King County Council, King County, Washington, a copy of the Department's findings and action recommending that the Zoning Map be amended and for the reasons stated therein; and

NOW THEREFORE BE IT ORDAINED that the King County Council does hereby adopt the findings and recommendations of the Department of Planning as its own and does hereby reclassify certain property to RS 15,000 as shown hereon and legally described herein which lies within the part(s) of the Zoning Map described as Area Map(s) E 1-25-5

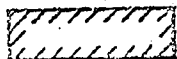
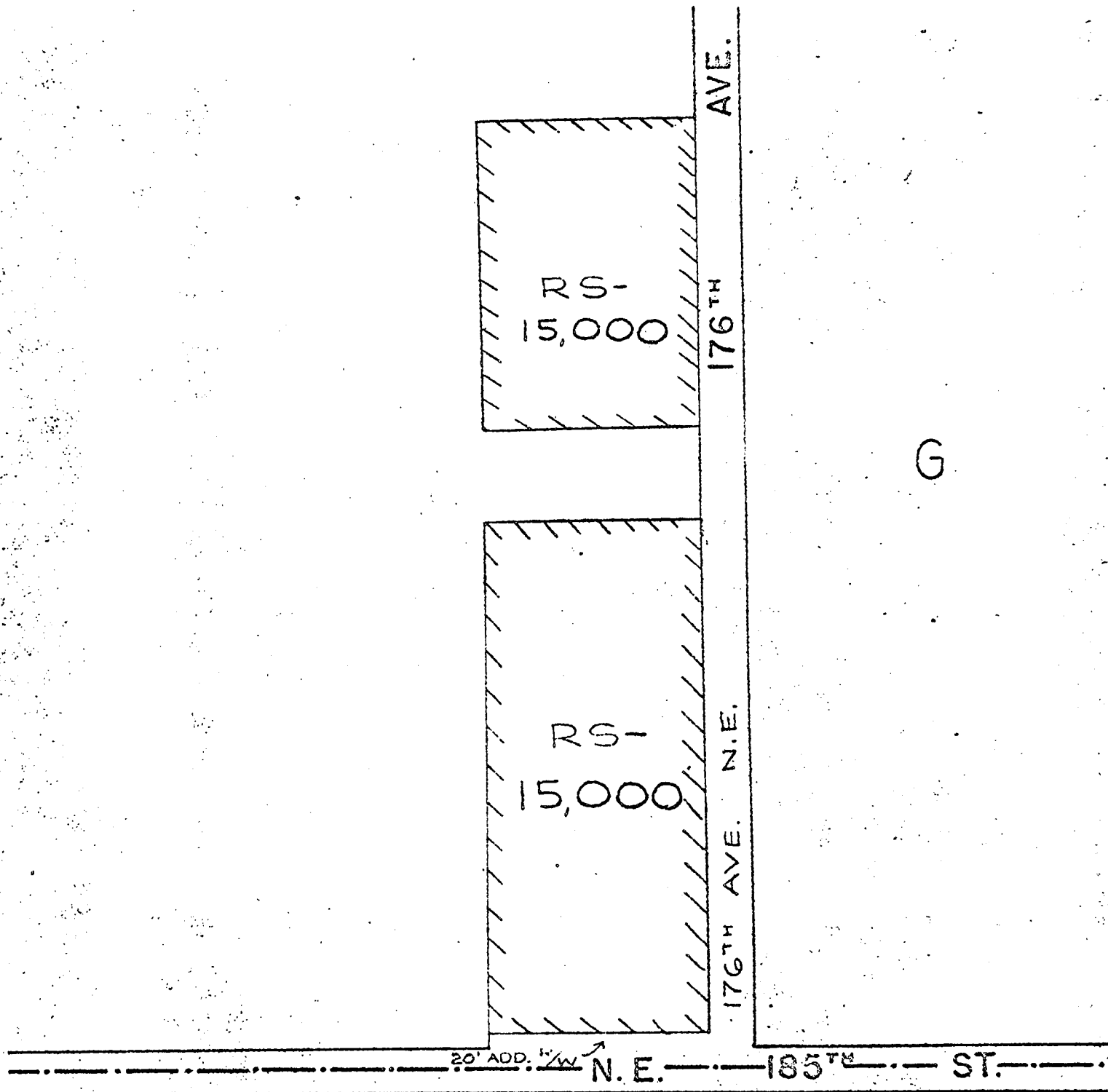

AREA RECLASSIFIED
BY THIS RESOLUTION



Ordinance No. 0030

Planning Agency No. P 68-224

LEGAL DESCRIPTION:

The east half of the east half of the southwest quarter of the southeast quarter of Section 1, Township 26 North, Range 5 East, W. M., in King County, Washington, EXCEPT the south 132 feet of the north 577 feet and EXCEPT County roads.

PASSED this 9th day of June, 1969.

KING COUNTY COUNCIL
KING COUNTY WASHINGTON

W. T. O'Brien
CHAIRMAN

ATTEST:
RALPH R. STENDER
Clerk of the King County Council

Ralph R. Stender

A P P R O V E D

Date 6-12-69

ORDINANCE READINGS

1st May 19, 1969
2nd June 2, 1969
3rd JUN 9, 1969
Effective Date JUN 19, 1969

John D. Spellman
JOHN D. SPELLMAN
County Executive